



next generation led

info@nextgenerationled.be  
www.nextgenerationled.be  
Tel + 32 53 71 09 42

# Broadwing LED desk lamp

## Properties

- Lifespan L70 %: > 40.000hr
- High efficiency, sleek, visual comfort, precision lighting and stylish design
- Three different color temperatures
- Clamp and square base mounting
- 50min timer and three dimming levels available with touch switch on lamp
- Excellent uniformity
- Samsung LED
- Magnesium, aluminum, ABS, steel body
- Warranty: 2 years



## Specifications

Broadwing	20W
Input voltage	DC24V / 1A
Color rendering index	RA > 95
Color temperature	Cool: 5000K - Bright: 4000K - Warm: 2700K
Light Output	350lm ~ 1500lm
Power factor:	> 0.95
Dimension	Width: 800mm X (230 x 175 mm) (square base) X Height: 950mm

## Application

Workstations that need a min of 1000lux, offices, conference room, library, bookstore,...

Updated: October 2019



# Specifications

## LAMP HEAD ASSEMBLING GUIDE

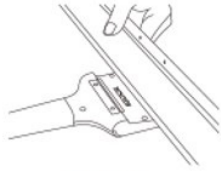

### STEP 01

Align the connecting pin of the lamp head with the connecting socket of the main unit

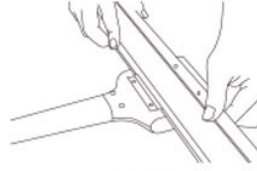

### STEP 02

Slide the lamp to the correct position

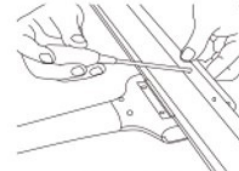

### STEP 03

Secure the lamp head to the main unit with the two screws provided

## CLAMP ASSEMBLING GUIDE

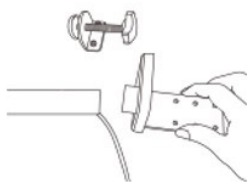

### STEP 01

Place the lamp on a flat post and push the clamp into the lamp post

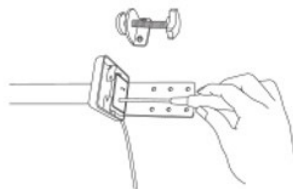

### STEP 02

Secure the clamp with the provided screws

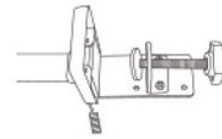

### STEP 03

Attach the mount to the clamp in the correct position to match the thickness of the table.

## BASE ASSEMBLING GUIDE

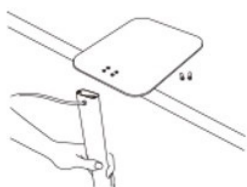

### STEP 01

Flip the base up on a flat floor.

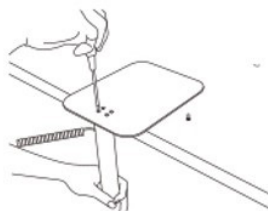

### STEP 02

Hold the body of lamp and secure it with provided 4 screws



### STEP 03

Complete !

## Specifications

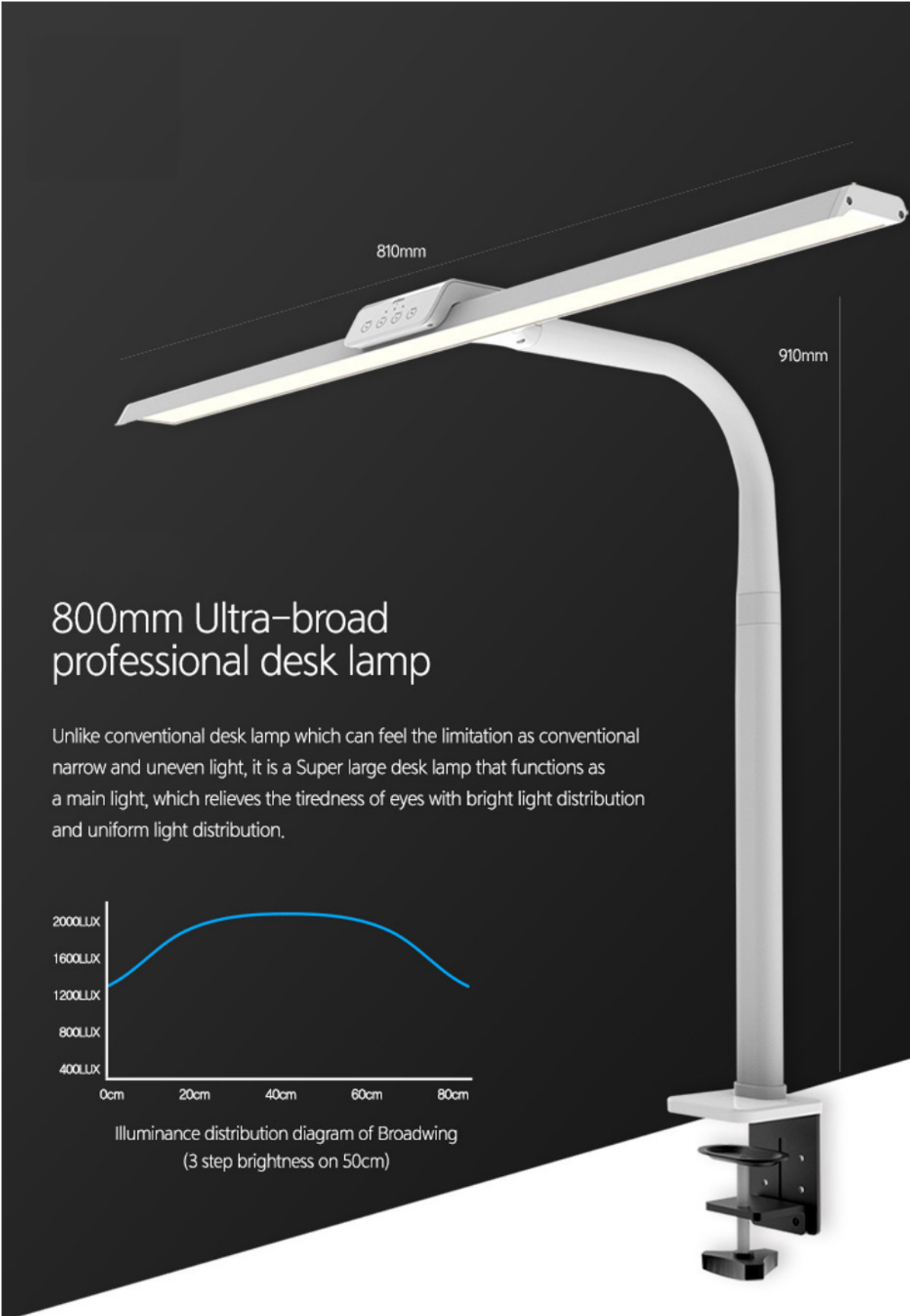

810mm

910mm

### 800mm Ultra-broad professional desk lamp

Unlike conventional desk lamp which can feel the limitation as conventional narrow and uneven light, it is a Super large desk lamp that functions as a main light, which relieves the tiredness of eyes with bright light distribution and uniform light distribution.

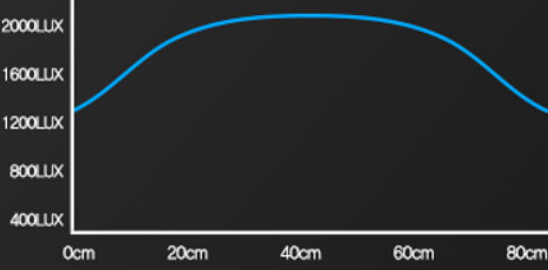

Distance (cm)	Illuminance (LUX)
0	1200
20	1800
40	1900
60	1700
80	1200

Illuminance distribution diagram of Broadwing  
(3 step brightness on 50cm)

## CIE 1931

The CIE color space, developed in 1931, is still used to define colors, and as a reference for other color spaces. The figure is a two-dimensional display of colors of the same intensity (brightness), which is based on observations of color measurements by people.

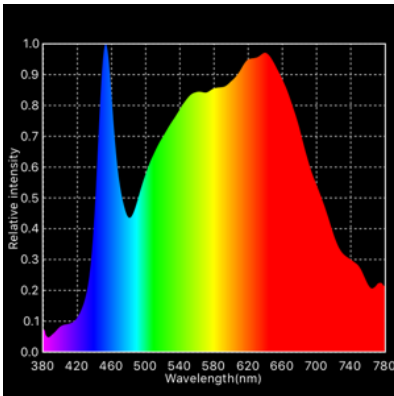
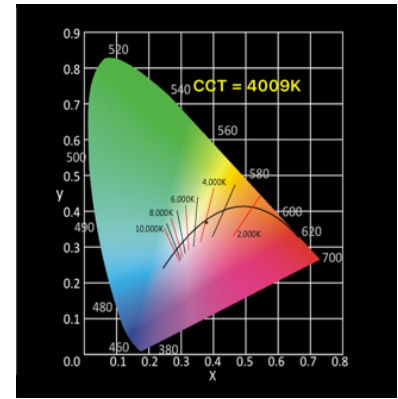

## SPECTRUM

Isaac Newton used the Latin word spectrum to define the color series which arose when he dropped a bundle of sunlight through a glass prism. The color spectrum consists of the colors of the rainbow with the color sequence red-orange-yellow-green-blue-indigo-violet, which corresponds to bearish wave length (increasing frequency) of the light waves.

## C78 377

ANSI C 78.377 is now the standard for color quality, as determined by the American National Standards Institute. ANSI recommends lamp manufacturers to stay within a 4-step ellipse. This means that manufacturers with a particular focus on the CIE diagram have a broad range of observable differences.

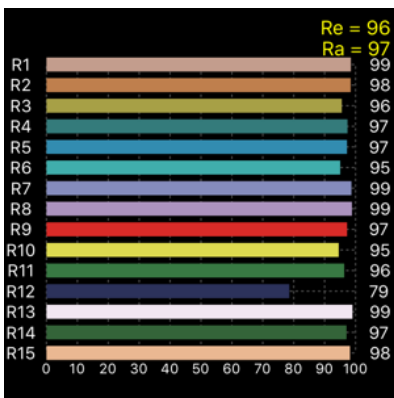
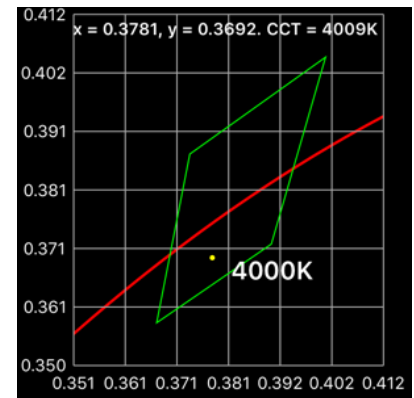

## CRI HISTOGRAM

The color reproduction of a light source indicates whether the color of an object can be displayed true to nature. The graph shows whether we can accurately determine color, depending on the color rendering properties of the light source.

Ra = average of R1 to R8

Re = average of R1 to R15

R9 = saturated red. Should be as high as possible.

## SDCM

SDCM is an acronym which stands for Standard Deviation Colour Matching. SDCM has the same meaning as a "MacAdam ellipse". A 1-step MacAdam ellipse defines a zone in the CIE 1931 2 deg (xy) colour space within which the human eye cannot discern colour difference. Most LEDs are binned at the 4-7 step level, in other words you certainly can see colour differences in LEDs that are ostensibly the same colour.

SDCM	CCT @ 3000K	$\Delta U_V$
1x	$\pm 30K$	$\pm 0.0007$
2x	$\pm 60K$	$\pm 0.0010$
4x	$\pm 100K$	$\pm 0.0020$
7-8x	$\pm 175K$	$\pm 0.0060$

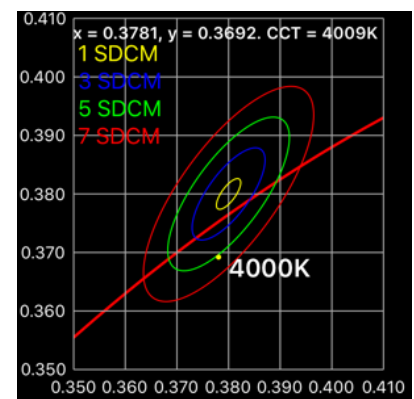



next generation led

## Broadwing Desk Lamp

REFERENCE	WATT	LUMEN	BODY COLOR	DIMMABLE	BASE
895-0025	20W	350-1500lm	Black	YES	Square+Clamp
895-0026	20W	350-1500lm	White	YES	Square+Clamp

